

From: Mark Preece
Sent: 9 Jul 2020 08:30:50 +1200
To: monitoring
Subject: RE: Location of Forsyth salmon farm structures
Attachments: DR-051103-065R23.pdf

Hi Claire

We've made a minor mooring alteration which is shown in this version of the mooring report for Forsyth Bay.

Thanks

From
Mark

From: Mark Preece
Sent: Tuesday, 9 June 2020 7:00 AM
To: monitoring <monitoring@marlborough.govt.nz>
Subject: Location of Forsyth salmon farm structures

Kia ora Claire

Please see attached the latest plan showing the location of the farming structures at Forsyth.

Thanks

From
Mark

Mark Preece



+64 2 92489440 | www.kingsalmon.co.nz | 43 Dublin Street, Picton, 7220.

Internet e-Mail Disclaimer: All information in this message and attachments is confidential and may be legally privileged. Only intended recipients are authorised to use it. Views and opinions expressed in this e-mail are those of the sender and do not necessarily reflect the views of the company. E-mail transmissions are not guaranteed to be secure or error free and The New Zealand King Salmon Co Ltd accepts no liability for such errors or omissions.

This e-mail message has been scanned by **SEG Cloud**

COORDINATE SCHEDULE						
	NEW ZEALAND MAP GRID		WGS 84 (DD MM.mmmm)		NZTM	
	EASTING	NORTHING	LATITUDE	LONGITUDE	EASTING	NORTHING
A	2595593.1	6024616.0	40° 58.8346'S	174° 01.0362'E		
B	2595742.1	6024601.5	40° 58.8415'S	174° 01.1426'E		
C	2595703.8	6024205.4	40° 59.0558'S	174° 01.1186'E		
D	2595554.5	6024217.9	40° 59.0500'S	174° 01.0120'E		
NW LICENSE	2595637.5	6024515.5	40° 58.8875'S	174° 01.0705'E		
NE LICENSE	2595694.8	6024552.5	40° 58.8671'S	174° 01.1111'E		
SE LICENSE	2595665.2	6024246.3	40° 59.0327'S	174° 01.0925'E		
SW LICENSE	2595600.5	6024252.6	40° 59.0295'S	174° 01.0464'E		
1			40° 58.8349'S	174° 01.0397'E	1685610.3	5462891.0
2			40° 58.8373'S	174° 01.0774'E	1685642.0	5462909.6
3			40° 58.8392'S	174° 01.1058'E	1685674.0	5462889.7
4			40° 58.8416'S	174° 01.1425'E	1685736.4	5462854.5
5			40° 58.8951'S	174° 01.1365'E	1685716.7	5462785.4
6			40° 58.9186'S	174° 01.1338'E	1685712.8	5462741.3
7			40° 58.9421'S	174° 01.1312'E	1685708.4	5462695.9
8			40° 58.9656'S	174° 01.1286'E	1685704.5	5462654.4
9			40° 58.9891'S	174° 01.1259'E	1685700.3	5462611.5
10			40° 59.0532'S	174° 01.1188'E	1685686.7	5462487.9
11			40° 59.0515'S	174° 01.0829'E	1685637.2	5462498.9
12			40° 59.0492'S	174° 01.0517'E	1685594.6	5462499.7
13			40° 59.0475'S	174° 01.0158'E	1685566.3	5462499.1
14			40° 58.9824'S	174° 01.0231'E	1685556.3	5462625.0
15			40° 58.9590'S	174° 01.0257'E	1685560.0	5462668.4
16			40° 58.9355'S	174° 01.0284'E	1685564.1	5462711.3
17			40° 58.9120'S	174° 01.0310'E	1685568.3	5462755.1
18			40° 58.8885'S	174° 01.0336'E	1685571.7	5462796.2
19	2595715.4	6024360.3	40° 58.9720'S	174° 01.1255'E	1685702.0	5462645.1
20	2595573.2	6024374.3	40° 58.9654'S	174° 01.0240'E	1685559.8	5462659.1
21	2595709.3	6024289.0	40° 59.0106'S	174° 01.1218'E	1685695.9	5462573.8
22	2595677.4	6024209.5	40° 59.0537'S	174° 01.0997'E	1685664.0	5462494.4
23	2595563.1	6024221.3	40° 59.0481'S	174° 01.0181'E	1685549.7	5462506.1
24	2595564.0	6024303.5	40° 59.0037'S	174° 01.0181'E	1685550.7	5462588.3

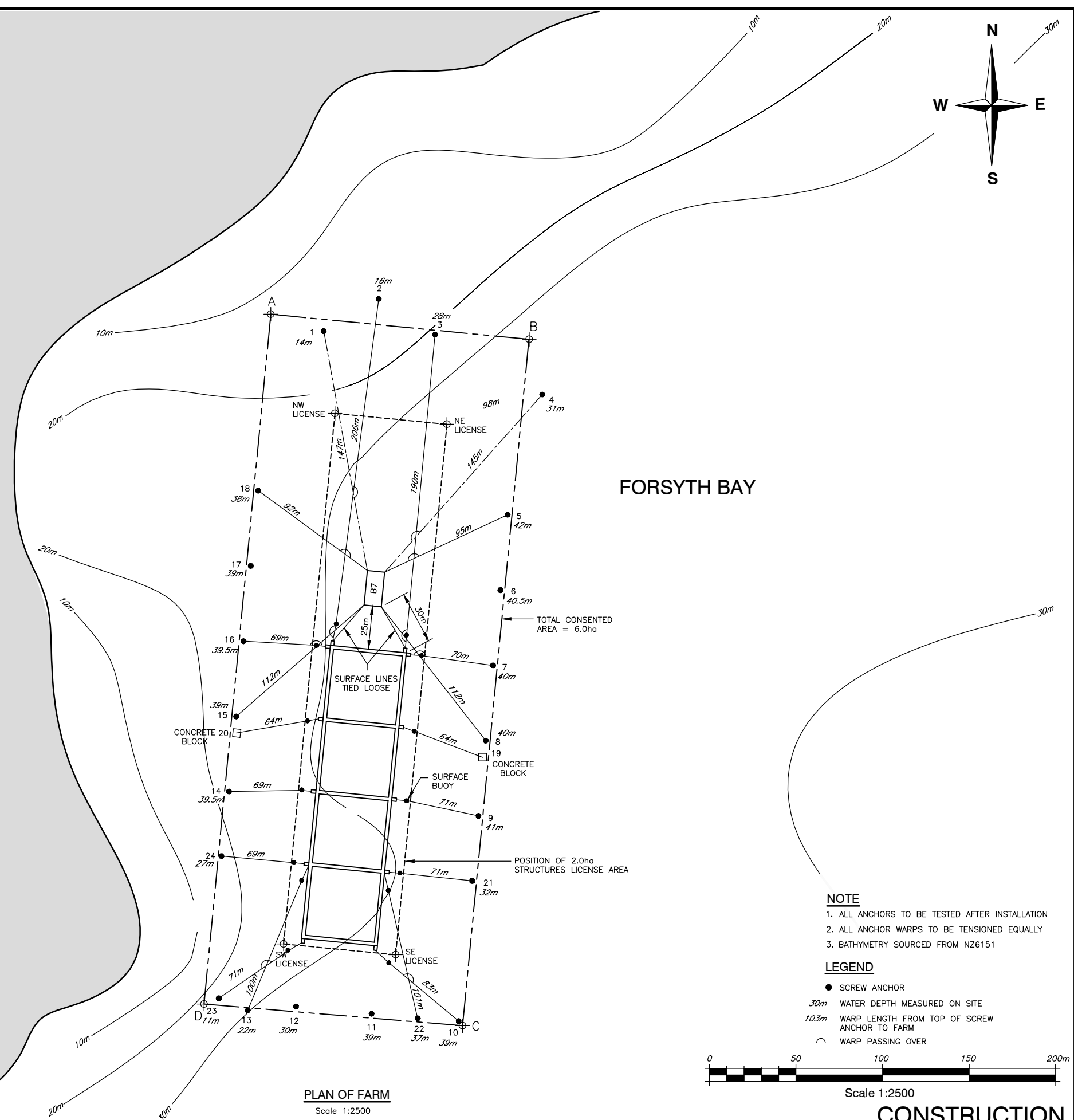
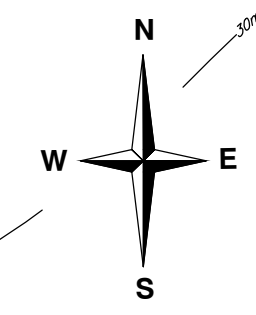

FORSYTH BAY

TOTAL CONSENTED AREA = 6.0ha

POSITION OF 2.0ha STRUCTURES LICENSE AREA

- NOTE**
1. ALL ANCHORS TO BE TESTED AFTER INSTALLATION
 2. ALL ANCHOR WARPS TO BE TENSIONED EQUALLY
 3. BATHYMETRY SOURCED FROM NZ6151

- LEGEND**
- SCREW ANCHOR
 - 30m WATER DEPTH MEASURED ON SITE
 - 103m WARP LENGTH FROM TOP OF SCREW ANCHOR TO FARM
 - WARP PASSING OVER

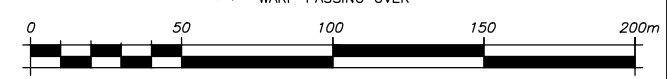

Scale 1:2500

CONSTRUCTION

Amendments	Rev'n	Date	Drawn	Issued for	Checked	Approved	Date
AS BUILT ANCHOR LOCATIONS FOR 21-24 ADDED	23	08/06/2020	RVE	CONSTRUCTION	GCT	GCT	09/09
FARM MOVED TO SOUTHERN END OF FARM	22	06/05/2020	RVE	CONSTRUCTION	GCT	GCT	
BARGE CHANGED TO B7, AS BUILT ANCHOR LOCATIONS SHOWN	21	23/03/2020	RVE	CONSTRUCTION	GCT	GCT	
CAGES AND BARGE ADDED	20	15/06/19	RVE	CONSTRUCTION	GCT	GCT	

OCEL CONSULTANTS NZ LIMITED

272-276 Antigua Street
PO Box 877
Christchurch
Tel (03) 3790444
Fax (03) 3790333

49 Crown Hill Street
PO Box 151
New Plymouth
Tel (067) 512310
Fax (067) 512310

This drawing and its content is the property of OCEL Consultants NZ Limited

Any unauthorised use or reproduction of it is forbidden

NZ KING SALMON CO. LTD

FORSYTH BAY SALMON FARM

PLAN OF 40404 CONFIGURATION

Scale (A3)	ACAD Filename
1:2500	051103/DR-051103-065R23
Drawing No.	Rev.
DR-051103-065	23